

WARNINGS

- Do not mount accessories in front of or near the path of airbag deployment.
- Check vehicle compatibility before install to avoid damage to the vehicle mount point.
- Designed to work with OEM dashboard only, not compatible with aftermarket modifications.
- Do not use with 3rd party extension arms. Adhere to our phone weight limits.
- Mount electronics away from airflow to prevent heat damage.

Self-installation instructions and advice are provided for your convenience. It is your responsibility to determine if you have the knowledge, skills, and physical ability required to properly perform an installation. Offroom shall have no liability for damage or injury resulting from the installation or use of any Offroom or third party products. It is your responsibility to ensure that all products are installed in adherence with local laws and regulations and in such a manner as to allow a vehicle to be operated safely and without distraction. Offroom product warranties do not cover the installation, removal or re-installation of any product.

WATCH THIS INSTALL

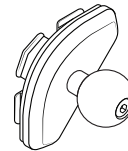

Mounting Base Installation Instructions

Toyota Tundra 2022-2025
Toyota Sequoia 2023-2025

COMPONENTS

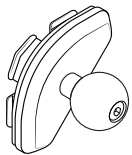

Mounting Base

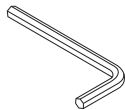

L-key

01

Using the L-key provided, slightly loosen the screw to ensure the rear plate moves.

Do not fully remove the screw - keep about one thread engaged.

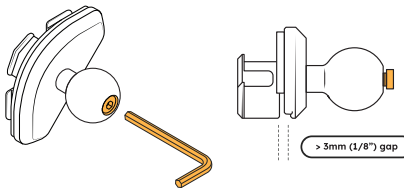

02

Position mounting base near the upper outer corner of the center air vent on the driver or passenger side.

Slide mounting base upward so the tabs engage the top lip of the air vent.

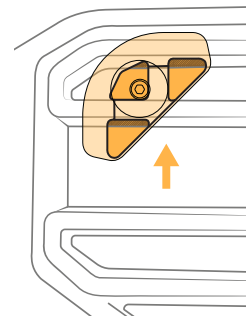

03

Slide the mounting base fully into the corner of the air vent.

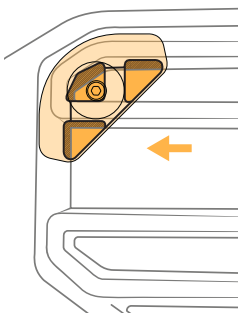

04

Using the L-key, alternate tightening screw until mounting base has a snug fit.

To ensure the best fit possible, hold mounting base while tightening.

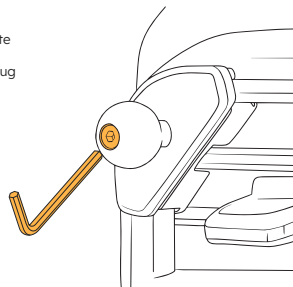

POSITIONING

Fits upper outer corners of centre console air vents as shown.

