

### WARNINGS

- Do not mount accessories in front of or near the path of airbag deployment.
- Check vehicle compatibility before install to avoid damage to the vehicle mount point.
- Designed to work with OEM dashboard only, not compatible with aftermarket modifications.
- Do not use with 3rd party extension arms. Adhere to our phone weight limits.
- Mount electronics away from airflow to prevent heat damage.

Self-installation instructions and advice are provided for your convenience. It is your responsibility to determine if you have the knowledge, skills, and physical ability required to properly perform an installation. Offroom shall have no liability for damage or injury resulting from the installation or use of any Offroom or third party products. It is your responsibility to ensure that all products are installed in adherence with local laws and regulations and in such a manner as to allow a vehicle to be operated safely and without distraction. Offroom product warranties do not cover the installation, removal or re-installation of any product.

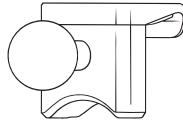

Mounting Base



L-key

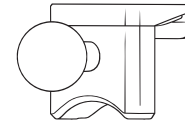

## Mounting Base Installation

Lexus GX 550 2024-2026

01

Using the L-key provided, slightly loosen the screws to ensure the inner plate moves. Do not fully remove the screws - keep about one thread engaged.

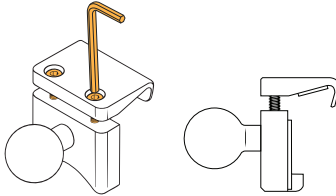

02

Align the centre of the mounting base with the centre line of the vehicle Start Stop button (01).

Hook the upper mounting base plate lip around the top edge of the dash as shown (02)

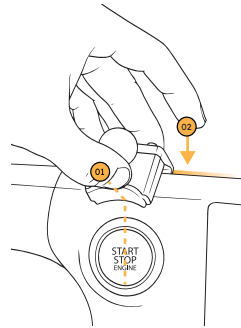

03

Align bottom base plate with the outer bezel of the Start Stop button and push into position.

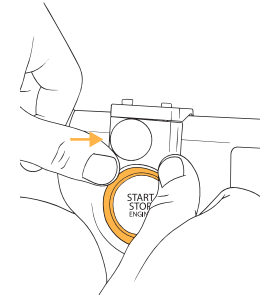

04

Using the L-key, hand tighten the screws until the mounting base has a snug fit.

To ensure best fit, hold mounting base into position with as shown while tightening.

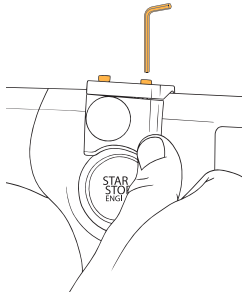

## POSITIONING

Fits in the positions shown.

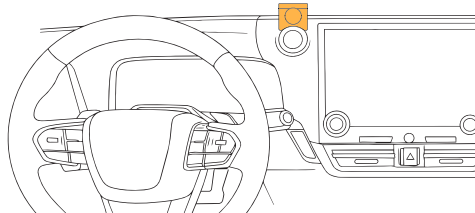

WATCH THIS INSTALL

