

Watch This Install



SUPPORT
hello@getoffroad.com
415 - 592 - 7626

WARNINGS

- Do not mount accessories in front of or near the path of airbag deployment.
- Check vehicle compatibility before install to avoid damage to the vehicle mount point.
- Designed to work with OEM dashboard only, not compatible with aftermarket modifications.
- Do not use with 3rd party extension arms. Adhere to our phone weight limits.
- Mount electronics away from airflow to prevent heat damage.

COMPONENTS

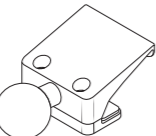

Mounting Base



Trim Tool

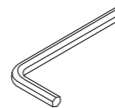

L-key

01

Using the L-key provided, slightly loosen the screws to ensure the lower plate moves.

Do not fully remove the screws - keep about one thread engaged.

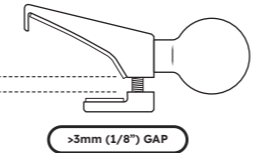
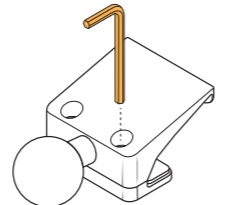

02

Insert the trim tool into the dash seam to the depth shown, to create a gap.

Slide the lower mounting base plate (01) under the air vent bezel as shown, and press the lip of the upper plate (02) into the created gap.

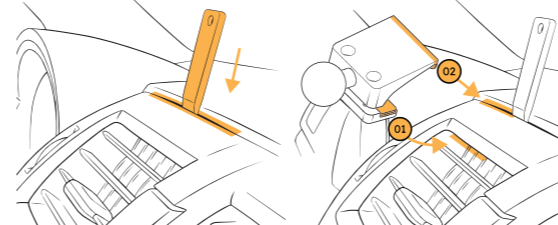

03

Remove the trim tool.

Using the L-key, alternate tightening screws until mounting base has a snug fit.

To ensure the best fit possible, hold mounting base while tightening.

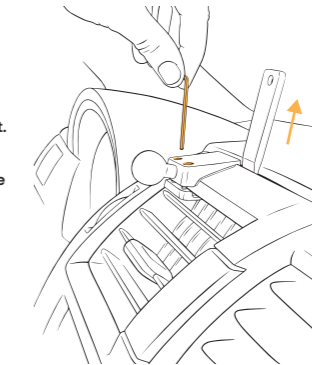

POSITIONING

Fits on the top edge of the driver and passenger air vents on center console. Outer position recommended for phone access.

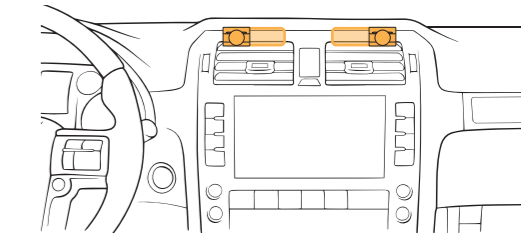

OFFROAM

Self-installation instructions and advice are provided for your convenience. It is your responsibility to determine if you have the knowledge, skills, and physical ability required to properly perform an installation. Offroam shall have no liability for damage or injury resulting from the installation or use of any Offroam or third party products. It is your responsibility to ensure that all products are installed in adherence with local laws and regulations and in such a manner as to allow a vehicle to be operated safely and without distraction. Offroam product warranties do not cover the installation, removal or re-installation of any product.

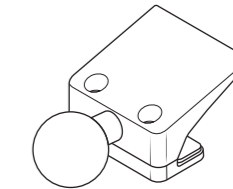

Mounting Base Installation Instructions

Lexus GX460 2010-2021